

# ONE

SUBIACO

---

ROBERTS  
FLOORPLANS

CRAFTED BY  
**BLACKBURNE**

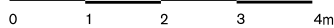
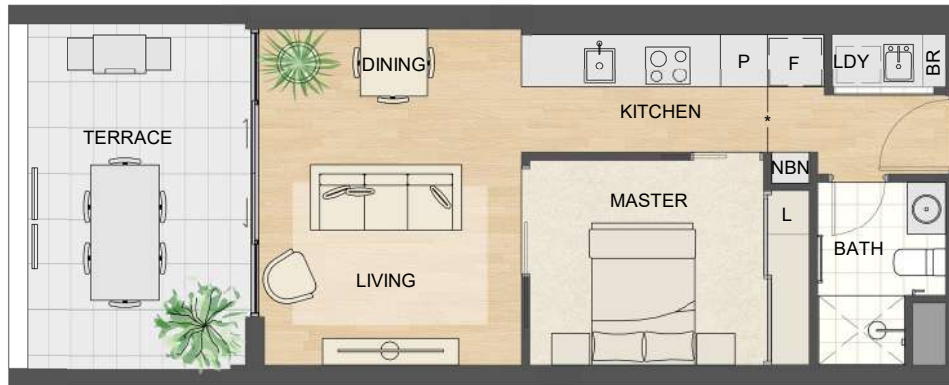

### Details

Beds	1
Baths	1
Car bays	1
Store	1
Internal	45m <sup>2</sup>
Terrace	12m <sup>2</sup>
Total	57m <sup>2</sup>

### Location

<b>Residence</b>	213, 308, 313, 407, 412
<b>Similar</b>	419, 507*, 512
<b>Levels</b>	02 - 05

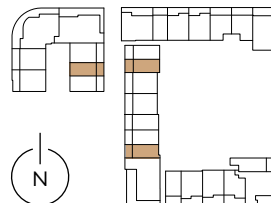

### Notes

**For all similar apartment plans, the following variations apply**

- Size or configuration of terrace or courtyard
- Type and extent of terrace cover and soffit finish
- Type or configuration of balustrade and dividing screens
- Size or location of windows
- Type, location and inclusion of screens
- Planter box inclusions
- \*Indicative line of reduced ceiling to 2300mm high (Residence 507 only)

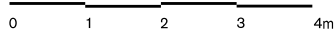

## Details

Beds	1
Baths	1
Car bays	0-1
Store	1
Internal	45m <sup>2</sup>
Terrace	14m <sup>2</sup>
Total	59m <sup>2</sup>

## Location

<b>Residence</b>	214
<b>Similar</b>	107, 314, 413, 513
<b>Levels</b>	01 - 05



## Notes

- For all similar apartment plans, the following variations apply**
- Size or configuration of terrace or courtyard
  - Type and extent of terrace cover and soffit finish
  - Type or configuration of balustrade and dividing screens
  - Size or location of windows
  - Type, location and inclusion of screens
  - Planter box inclusions

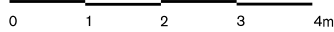
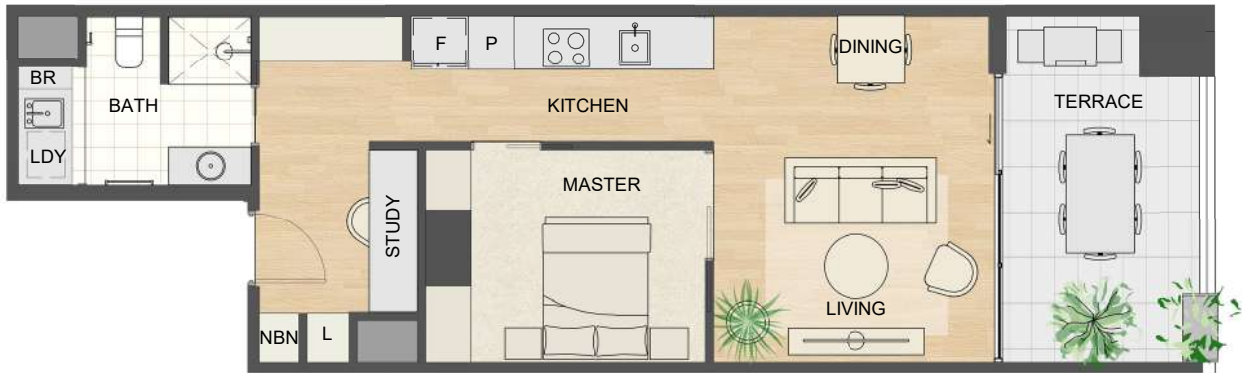

## Details

Beds	1
Baths	1
Car bays	1
Store	1
Internal	52m <sup>2</sup>
Terrace	12m <sup>2</sup>
Total	64m <sup>2</sup>

## Location

<b>Residence</b>	201
<b>Similar</b>	101, 301
<b>Levels</b>	01 - 03

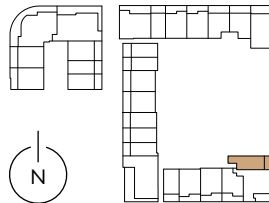

## Notes

- For all similar apartment plans, the following variations apply**
- Size or configuration of terrace or courtyard
  - Type and extent of terrace cover and soffit finish
  - Type or configuration of balustrade and dividing screens
  - Size or location of windows
  - Type, location and inclusion of screens
  - Planter box inclusions

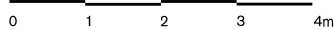

## Details

Beds	2
Baths	1
Car bays	1
Store	1
Internal	74m <sup>2</sup>
Terrace	14m <sup>2</sup>
Total	88m <sup>2</sup>

## Location

<b>Residence</b>
<b>Similar</b>
<b>Levels</b>
3-5



## Notes

**For all similar apartment plans, the following variations apply**

- Size or configuration of terrace or courtyard
- Type and extent of terrace cover and soffit finish
- Type or configuration of balustrade and dividing screens
- Size or location of windows
- Type, location and inclusion of screens
- Planter box inclusions

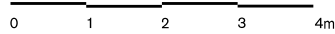

**Details**

Beds	2
Baths	1
Car bays	1
Store	1
Internal	74m <sup>2</sup>
Terrace	20m <sup>2</sup>
Total	94m <sup>2</sup>

**Location**

<b>Residence</b>
<b>Similar</b>
<b>Levels</b>
2



**Notes**

- For all similar apartment plans, the following variations apply**
- Size or configuration of terrace or courtyard
  - Type and extent of terrace cover and soffit finish
  - Type or configuration of balustrade and dividing screens
  - Size or location of windows
  - Type, location and inclusion of screens
  - Planter box inclusions

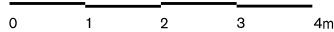

## Details

Beds	2
Baths	1
Car bays	1
Store	1
Internal	73m <sup>2</sup>
Terrace	14m <sup>2</sup>
Total	93m <sup>2</sup>

## Location

<b>Residence</b>
<b>Similar</b>
<b>Levels</b>
3-5



## Notes

**For all similar apartment plans, the following variations apply**

- Size or configuration of terrace or courtyard
- Type and extent of terrace cover and soffit finish
- Type or configuration of balustrade and dividing screens
- Size or location of windows
- Type, location and inclusion of screens
- Planter box inclusions

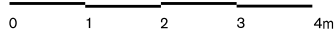

### Details

Beds	2
Baths	1
Car bays	1
Store	1
Internal	73m <sup>2</sup>
Terrace	20m <sup>2</sup>
Total	73m <sup>2</sup>

### Location

<b>Residence</b>
<b>Similar</b>
<b>Levels</b>
2

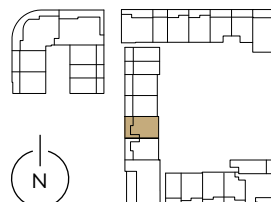

### Notes

- For all similar apartment plans, the following variations apply**
- Size or configuration of terrace or courtyard
  - Type and extent of terrace cover and soffit finish
  - Type or configuration of balustrade and dividing screens
  - Size or location of windows
  - Type, location and inclusion of screens
  - Planter box inclusions





## Details

Beds	3
Baths	2
Car bays	2
Store	1
Internal	135m <sup>2</sup>
Terrace	51m <sup>2</sup>
Total	186m <sup>2</sup>

## Location

<b>Residence</b>	207
<b>Similar</b>	307, 406, 506*
<b>Levels</b>	02 - 05

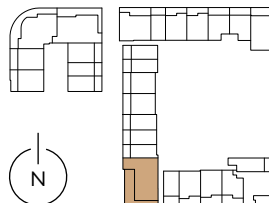

## Notes

**For all similar apartment plans, the following variations apply**

- Size or configuration of terrace or courtyard
- Type and extent of terrace cover and soffit finish
- Type or configuration of balustrade and dividing screens
- Size or location of windows
- Type, location and inclusion of screens
- Planter box inclusions
- \*Indicative line of reduced ceiling to 2300mm high (Residence 506 only)